

BOTLEY NEWS

Botley Bypass News

Botley experiences high volumes of through traffic using the A334 Botley High Street and the possibility of a road to bypass the village has been under discussion for many years.

In the summer of 2016 Hampshire County Council held three public exhibitions to showcase plans for the proposed Botley Bypass, as well as displaying plans in the local library. Over 730 local residents attended the exhibitions and 501 questionnaires were completed - of which 82 per cent supported the principal that Botley should have a Bypass. In November 2017 Hampshire County Council's proposed scheme for a brand new 1.8 kilometre single carriageway road was finally granted formal planning approval.

The Bypass will divert traffic from the main A334 through Botley, north from Maypole roundabout onto an improved Woodhouse Lane, and then south east onto the new Bypass running to the south of the railway line - which would then re-join the A334 at the junction near to Pinkmead Farm. Approximately 80% of traffic currently passing through Botley is non-local through traffic. This traffic will be encouraged to divert onto the Bypass. The scheme will provide opportunities for major improvements in the High Street, which will be based around a traffic calming scheme.

The road will cost an estimated £26 million and last month it was announced that the Government had awarded £10 million towards the project following a joint formal funding application from the County and Borough Councils. Developer contributions and County Council capital grants will make up the balance. Ground surveys, environmental mitigation work and land acquisitions can now go ahead in the area, to enable detailed designs to be finalised.

The County Council's Executive Member for Environment and Transport, Councillor Rob Humby, said: "The Bypass has been a long-standing ambition for local residents, and the County and District Councils and I am very pleased that the significant work we have put into developing a scheme has now paid off. It will dramatically improve quality of life in the area by removing through traffic from the village, reducing noise and making a major contribution to improving local air quality. The Bypass will also provide extra capacity to cope with the proposed increase in traffic in the area over the coming years."

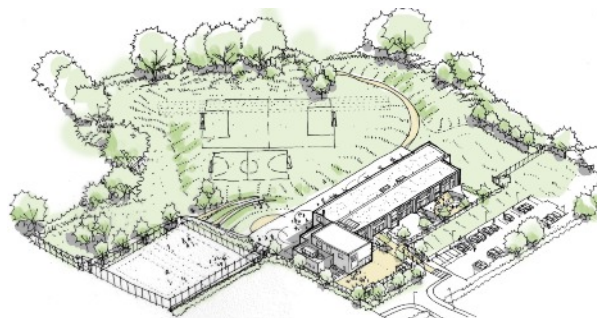

Plans for a new 2-form entry primary school at Boorley Park have been submitted to the County Council. The plans consist of a two-storey building with a single storey kitchen/plant room attached, grass sports pitch and hard courts and a staff car park.

PARISH COUNCIL GRANTS FOR COMMUNITY GROUPS



Does your group need funding for a new project or equipment?

Every year the Parish Council awards grants to support the work and activities of community groups based in Botley.

Application forms available from the Parish Office, Botley Centre, High Street Recreation Ground.

Telephone 01489 787181 or
email parish.clerk@botley.com

LEST WE FORGET...

2018 will see the centenary of the end of World War I. The war memorial in All Saints churchyard and the memorial tablet at Nursesland (the area adjacent to the crossing opposite Botley School) will be cleaned and renovated as part of a Parish Council project to mark the occasion.

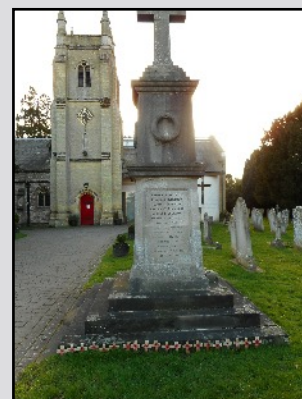

GET TO KNOW YOUR BOTLEY COUNCILLORS

Every edition of the Botley News carries a section with Botley Parish Councillors names and contact details. It's useful information, but sometimes it's good to know a little more about people and be able to put faces to names, so over the past year we have given profiles of Councillors in their own words.

My name is Ron Clark and I have lived in Botley for almost 14 years. I spent nearly 45 years working in electronics and computer industries in London, until redundancy and early retirement led to my relocating to Botley. I was aided in which move by a country and seaside housing scheme run by the Greater London Council.



Following a period of working for my housing association on various forums and committees I became involved with the Parish Council as a transport rep, attending forums and meetings across Hampshire. I decided to get more involved and was co-opted on to the Council. I was re-elected as a councillor in 2012 and have at various times served on all the Council's committees. I am currently Chair of the Planning and Highways Committee.

My aims have always been to serve the community and to preserve the rural nature of the village.

Botley Calendar

For the last two years Botley Parish Council has produced a free calendar, delivered to all residents. 2017's calendar featured photos from around the parish taken by residents. A competition was held to decide which pictures would be used. The 2018 calendar has pictures of local scenes by local artists.

The Parish Council would like to have your feedback on this initiative : Do you like it? Should one be produced every year? If so, what should be the theme for a 2019 calendar?

Please contact us with your ideas/views by emailing parish.clerk@botley.com, calling 01489 787181 or writing to Botley Parish Council, The Botley Centre, High Street Recreation Ground, Botley, Southampton SO30 2ES.

Hello, my name is Jacquie Rolls and I started working for Botley Parish Council in November as a Community Development Worker; the job is part-time, Monday - Wednesday. This is a new post for the Parish Council in preparation for the community growth and expansion arising from the Boorley Park development. The primary aim is to support the integration of the residents of Boorley Park within the wider community by developing and co-ordinating activities and services.



I have wide experience of working in community related roles, starting with CABINS Playbus, providing activities and support to families and young people living in Southampton; from there I went to work for Eastleigh Borough Council coordinating children's play schemes, supporting after school clubs and advising community groups and centres. Later I joined a team based in Winchester, assisting the voluntary sector groups providing support services and activities for older people living in rural communities and helping to start up new activities. My last job before joining Botley Parish Council was working for a local housing association with communities in Portsmouth, Havant, Gosport, Fareham, Eastleigh and Southampton.

You may have already met me in Botley as I have been out and about visiting local groups, activities and venues to introduce myself and find out about what is going on in the area; meeting both volunteers and the people who benefit from what they do.

I've also been looking at how people find out about the different activities, services and resources in the area and with this in mind I am working on a project to produce a Parish Council community information guide, designed to collect all of the local relevant information on services and resources together in one place. As Boorley Park grows I will be working with residents and exploring ways to help them share in the development of new community facilities.

If you are involved with a local group/activity or provide a community resource and you haven't heard from me yet please do get in touch as it would be great to meet you. I also receive regular information about local events, training, resources etc which I can share with you. I am available to offer advice and support to groups or help with the development of ideas for new community activities and projects.

Jacquie Rolls, Community Development Worker
Botley Parish Council
The Botley Centre, High Street, Botley SO30 2ES
Tel: 01489 787181, email: Jacquie.rolls@botley.com

Centrally located with ample parking
Small, medium & large rooms
Disabled access and toilets
All hire rooms have hearing loops

**THE BOTLEY
CENTRE:**
HELPING YOU
TO HOST
YOUR EVENT



For enquiries and bookings contact
Wendy Whitfield, Bookings Manager
Tel: 07834 171061
E-Mail: wendy.whitfield@botley.com

Take the F Words Challenge: Be Fit, Fabulous and have Fun!

Taking more exercise doesn't have to be a chore; try some of these ideas to get more activity into your life and make new friends as well.

PLAY WALKING FOOTBALL AT BOTLEY

5-a-side football, no slide tackling, no running, low impact but still competitive and played with passion!

Cost: £3 per session
pay on the day

Two 90 minute sessions a week, come to one or both.



Mondays 1 - 2.30pm

Wednesday 11.30am - 1pm

For more information contact
the Parish Office: 01489 787181

HEALTHWALKS IN BOTLEY

The walks take about 1 hour and are a great way to socialise and get some exercise. Everyone is welcome. The walks are led by a qualified Volunteer Walk Leader and take place rain or shine!

**Meet at the Botley Centre, High Street
Recreation Ground at 2pm every Wednesday**

For more information call 02380 684813
(Healthwalks Office)

Regular walking can help prevent heart disease, obesity, high blood pressure, osteoporosis and diabetes.



THIS GIRL CAN Eastleigh is brought to you by Eastleigh Borough Council. We want you to watch our campaign trailer and get inspired to try something new and take that first step towards regular activity.

The trailer features real women who take part in Eastleigh-based classes, clubs and activities; active women who are doing their thing, no matter what their shape, ability or how red faced they get.

Watch at www.eastleigh.gov.uk/thisgirlcan

Fear of judgement is stopping many women from taking part in physical activity. But it doesn't have to.

Even the smallest step is a step in the right direction.

You don't have to be sporty to exercise, just be yourself; be the girl who decides to go for it!

Find out more at www.eastleigh.gov.uk

Botley NeighbourCare: people helping people

We all want to live in a place where we can feel happy and safe, knowing our neighbours and helping and supporting each other. But over the years much has changed within our society and families are not always close to hand to help; they have their own working lives and family demands. Botley NeighbourCare is here to help in these sort of situations.

Volunteers to use their own cars to transport a wide variety of clients to medical appointments, dentists, opticians etc. Others help with small DIY jobs like changing light bulbs.

We also have a social Calendar - twice monthly outings to places of interest, to the cinema, to gardens or perhaps for lunch with a speaker. To find out more pick up a leaflet from All Saints Church or contact Emma on 07825-330116.

Volunteering: There are no set days or times; you only give as much time as you are able. Those who use their cars are reimbursed a mileage rate. If you would like to know more about volunteering (it's not all driving, we have behind the scenes tasks) then please contact Lynne Line 01489-691627 or lynne.line6272@gmail.com.

Let's have a coffee and a chat, it won't cost you and if it's not for you, then at least we each know a new person in Botley!



The 'Out for Lunch Club' is a very new venture started in February and held at The Bugle Inn, in Botley Square every two weeks. It is aimed at

the over 50's, both male and female, offering a chance for socialising and enjoying a 2 course lunch with complimentary tea or coffee for £7.50 per head. The initial response has been fantastic which means booking is essential. To book phone 07928-537904 (not the Bugle). If there is no answer just leave a message we will get back to you as soon as possible.

Botley Mini Bus: Botley has its own 14 seater mini bus which is available to hire at a very reasonable rate for your club or organisation, on a non profit basis.

When you enquire all details will be sent to you; familiarisation of the Bus is given before you drive. Terms and conditions can be found at our web site www.botley.com/minibus
emailminibusbotley@gmail.com tel: 07946-087112

Community SpeedWatch

Speeding is an issue which is recognised as a major concern for many residents; this makes it one of the biggest community priorities for the Police.

Hampshire Constabulary can work with volunteers to set up Community SpeedWatch groups which enable members of the community to become police support volunteers and take action, helping to educate drivers and thus make their neighbourhoods safer places.

The community scheme can only take place in 20 mph and 30 mph limits or zones and although managed by local police neighbourhood policing teams, it is run by volunteers.

Volunteers use equipment that can monitor the speed of passing traffic and then record the details, later adding them to a database. Vehicle checks are then undertaken by the police and letters are then sent to the registered keepers advising them of their speed and reminding them of why it is a community concern.

Please note that Community SpeedWatch is an educational scheme, not enforcement. It is considered as the first tier response to speeding issues. If a problem persists, it can be escalated to tier two, meaning that enforcement can be undertaken by the police neighbourhood policing teams.

Hampshire Police would like to run SPEEDWATCH in BOTLEY to help prevent speeding and want your help.

Would you like to be a part of SpeedWatch? If you are definitely interested and want to take part please contact PCSO Steve Hill via email: Stephen.hill@hampshire.pnn.police.uk

If you are not sure but want to find out more then please feel free to stop a PC or PCSO whilst they are out and about on patrol - or visit the Hampshire constabulary website for more information on how SpeedWatch works.



NEIGHBOURHOOD POLICING TEAM

Hampshire Alert

FREE Crime & Community Information

www.hampshirealert.co.uk

Register yourself at
www.hampshirealert.co.uk

Information direct to you,
from local officers,
about the area where you live.

You will be notified of relevant
information, warnings and crime
directly, so you won't miss out
on important updates.

**Register on-line or collect a
form from the
Parish Council Office.**

Become a Volunteer Car Driver for Hampshire County Council



Do you enjoy driving and want to work
with people?

Do you want to help your local community?

About the role:

Volunteers use their own cars to transport a wide variety of clients including older people, people with learning and physical disabilities, children, parents & families.

Thousands of journeys take place each month to a variety of venues both within and outside of Hampshire. Destinations are wide-ranging but include day centres for adults, schools and respite centres for children.

Volunteers are reimbursed a mileage rate.

Full training is provided

Requirements:

Good driving skills and your own car
Enjoy working with people
Good communication and listening skills

Drivers will be asked to complete
A Criminal Record Check (DBS)
An Occupational Health Form
An on the road driving assessment in your own car (expenses for which are reimbursed).

For more information please contact:

Community Transport and
Contracts team 01962 845184
Community.transport@hants.gov.uk

BOTLEY IN BLOOM

20 years ago Botley in Bloom was formed by a small group who wanted to keep Botley Blooming Beautiful. We hold our Summer Gardening Competition Judging during July and anyone within the Parish may take part. Entry forms will be available from Bloomers Florists in June.

All types of categories are covered from a window box or a vegetable plot to a large garden, with every variation in between, so we've got your type covered. The categories are judged by experts from local Garden Centres and winners receive a perpetual Trophy and a very attractive hand-made terracotta plaque, which you've probably seen proudly displayed around the Village.

We think Botley is a wonderful place to live, but we can't keep Botley Blooming without YOUR help, so please enter our Competition this Summer.

BOTLEY GARDENING CLUB



Join this lively local club - for both active and "armchair" gardeners. Hear expert speakers on all sorts of topics; meet others interested in gardens and gardening; get advice and tips; enjoy social events like quizzes and visits to gardens.

What more could you ask for?

Ring the secretary on 784946 to find out more. We meet at the Market Hall on the 3rd Wednesday of the month at 7.30pm - do join us. Or why not enter our annual Horticultural Show on 8th September? Go on - have a go!

PROBUS CLUB OF HAMBLE VALLEY

We are a club for retired and semi-retired men. We meet in the Diamond Jubilee Hall at the Botley Centre on the 1st and 3rd Wednesday of the month, from 10am - 12 noon. At our meetings we enjoy good company and interesting talks on a wide variety of topics. New members are always welcome. For more information please contact the Secretary, Martin Mills on 01489 788659.

4 April:	Life as a Church Organist
18 April:	Chorus Endings
2 May:	The Law and Why It Matters
16 May:	Korean Spirit and Culture
6 June:	Tax, Care and Toy Boys
20 June:	The Hobby of Metal Detecting

BOTLEY FLORAL CLUB

Botley Floral Group started the New Year with a tea party and demonstration showing members how to make an arrangement either in a bottle or incorporating one. In February we had our AGM and a talk on how to get the best results from our cameras. In March we welcomed a professional demonstrator and in April there will be a workshop entitled 'Spring'.



One of our last workshops saw a florist come to show us how to make tied bunches (picture above). This was great fun.

Please join us at the Botley Centre at 1.30pm on the second Wednesday in the month and have fun with our jolly crowd - more details available from Christine Clemons on 01489 790522.

BRAIN TUMOUR RESEARCH

Brain tumours are indiscriminate; they can affect anyone at any age and they tear families apart. What's more, they kill more children and adults under the age of 40 than any other cancer... yet just 1% of the national spend on cancer research has been allocated to this devastating disease. There will undoubtedly be people in your local community affected by a brain tumour: you might already know someone.

Brain Tumour Research is a national charity striving to fund a network of dedicated research centres. We support the UK's largest group of laboratory-based scientists progressing world-class research into brain tumours, to improve treatments, survival rates and quality of life for patients, and ultimately find a cure. We are the only national charity dedicated to research into brain tumours and campaigning to increase the national investment in brain tumour research. We rely solely on the generosity of the general public.

Visit our website to find out what's happening and take part in some of the fundraising events in your region.

Please get in touch to discuss how we can work together. We look forward to hearing from you. Help us fund the fight. Together we will find a cure.

www.braintumourresearch.org
Phone 01908 867200

Registered charity number 1153487 (England and Wales) SC046840 (Scotland). Company limited by guarantee number 08570737

BOTLEY WI

Christmas, when members enjoyed a social evening and shared supper, seems a long time ago now. In January we discussed the proposed resolutions for adoption at the National AGM in Cardiff in June and our February meeting was a lovely New Year Celebration Dinner.

We now look forward to a busy year as Hampshire Federation WI is celebrating its Centenary with activities planned for each month of the year, including a cruise with tea, a concert at the Anvil, a summer picnic with a Beatles tribute band, an exhibition the The Discovery Centre in Winchester and on 13 May 'WIFest' at Eastleigh Recreation Ground, 11.00am to 4.00pm. This open to everyone so come and visit Botley WI on the Hoopla stall.

We also have our own activities to look forward to with a farm trip to the home of Lyburn Cheese, games evening and monthly speakers.

- 19 April: Terri Robinson - History of English Canals
17 May: Annual Meeting
21 June: Mary Braddock - Nature Rambling in Surrey
19 July: Elizabeth Townsend - Volunteering on the Thai/Myanmar Border.

*Meet Botley WI
Join us at the Market Hall, High
Street, Botley
for tea and cake.*

*16 June 2.00 to 4.00pm
Displays of our activities*



*Try something new,
meet new people*

Our WI meetings are held in the Market Hall, Botley 7.30 pm on the third Thursday of the month. Feel free to come along and visit us for a meeting or come to our tea afternoon to see what we do. We have a craft group, reading group and walking group. If you would like to know more telephone 01489 781765.

Botley Choral Society

Spring Concert

*European Sacred Anthems
Purcell – Rejoice in the Lord
Purcell – Come Ye Sons of Art*

Saturday 17 March at 7.30pm, Holy Trinity Church, Gosport
Sunday 18 March at 7.30pm, All Saints' Church, Botley

Tickets £14 (£12 concessions)

From: Parish Office, All Saints Church, Botley: 01489 782445
Online: www.Botleychoral.co.uk or Tel: 07941 884419

BOTLEY MARKET HALL ANNUAL GENERAL MEETING THURSDAY 3 MAY 7.30pm

**At the Market Hall. Everyone in Botley is invited.
Speaker – Louise Evans, local beekeeper**

Your chance to have a say in what goes on in YOUR Market Hall and find out how you can get involved!

It is run by a local charity, and relies totally on local volunteers. Why not join us - we're a lively and friendly team; no experience needed.

The Hall accommodates about 20 clubs and groups serving many needs and interests.

Ring Derek Oswald on 781155 to find out more

You can hire the Hall by ringing 07733553408

Botley Bridge Magazine

Botley Bridge is a monthly community magazine produced by All Saints Church, Botley. It is a subscription magazine with a circulation of about 500 containing news items, articles and information about Botley events.

You can publicise your club, organisation or event by submitting an article for inclusion in Botley Bridge. Send copy to botley-mag@bcd-churches.org.uk

ZERO 4 PROBUS CLUB

Our club was formed in 2004. We are a friendly group of retired and semi-retired professional and business people who meet on the third Monday of the month (excluding August) at Brook Masonic Centre, Brook Lane, Botley.

Meetings start with a chat and refreshments at 11.00am before a short business meeting at 11.30. This is followed by a talk, often with slides or artefacts, for an hour or so before we enjoy a £10 single course lunch and hold a raffle.

We also have occasional day trips. Last year we had a very successful visit to the RNLI headquarters in Poole. We also visited Denbies Vineyard in West Sussex where we of course tasted the wines! This February we arranged a Sunday lunch at New Place Hotel, Shirrell Heath which was much enjoyed and which we hope to repeat periodically throughout the year.

Zero 4 Probus is an ideal gathering for couples or women and men who are alone and who would like to meet, socialise and make new friends and it offers a great opportunity to interact and enjoy the company of like-minded folk. We currently have eighty members but our constitution allows for up to a hundred.

Planned Talks for the coming months are:-

Monday 16 April: All you need to know about Roses

Monday 21 May: Netley Abbey

If you are interested you would be very welcome to come as a guest for two meetings before we invite you to join up. (The subscription has been held at £26.00 per annum.)

For more information and details please give me a call on 01489 891875 or look at our web-site www.zero4probusclub.weebly.com which has up-to-date information about the club's past activities and future meetings. We would love to meet you.

Malcolm Watson (Zero 4 Probus Club Secretary)

PARISH COUNCIL GRANT OPENS NEW CHAPTER FOR SCHOOL LIBRARY

Each year Botley Parish Council allocates a grant fund that community groups can access. This year the Friends of Botley School (FOBS) asked for support in the forthcoming move of the school's library to a new dedicated space.

The School had obtained money for building work but there was none available for the sort of improved resources and imaginative décor that helps inspire children and encourage a real love of reading. FOBS were delighted, therefore, when they were successful in an application to Botley Parish Council for funds towards new seating, display units, a rug and decorations. These complemented additional funding FOBS had raised for specialist books and new stock, including some from a sponsored read by the children.

In July the library was packed up and over the summer the building work was completed and the library furniture was relocated. It took a few weeks to shelve the books and reorganise the space but by the beginning of October the new library was ready to open.

The end result is a fantastic, fresh new space, a reinvigorated stock with many new, exciting and

engaging books plus a more inviting and comfortable user-friendly library. The children love the new space and the new rugs and relaxed seating proved an instant success. As the picture shows the school library is crucial to children's joy in reading and should be an inspirational space at the heart of the school for a long time to come.



Editor's Note: See front page to find out how your community group can apply for a grant from Botley Parish Council



FOBS

FRIENDS OF BOTLEY SCHOOL

The Friends of Botley School (FOBS) is the Parent Teacher Association (PTA) of Botley Church of England (controlled) Primary School.

We are a registered charity whose aim is to raise funds for the school by organising and running events for pupils and parents alike. Monies raised through these events are then used to purchase and fund items benefitting all year groups within the school. FOBS is run by a committee of parents and a ever-growing group of much appreciated volunteers.

Over the past three years FOBS has been fundraising for an Outdoor Classroom, in addition to the other

items of regular support. Receiving the necessary permissions to build the classroom was a long drawn-out process, involving local authorities and even the Department of Education.

FOBS donated over £20,000 for the Outdoor Classroom to be built. This included the purchase and construction of the classroom, and having the necessary electric, heating, air handling and alarm systems installed to make this a year-round facility. A huge thank you to everyone who has supported FOBS events over recent years - your support is really appreciated and we are so proud to have funded this fantastic facility, which will be a huge benefit, enhancing the children's learning in so many ways whilst allowing more teaching sessions to be held in the great outdoors.

On Wednesday 13 December 2017 the Reverend Gregg Mensingh blessed the classroom and Mr Kevin Barton, Chairman of the Board of Trustees, cut the ribbon. The School Councillors made the most of the opportunity to have a good look at their new classroom. Also present at the opening ceremony were James and Alison Potter from 'The Linked In Man', and Paul and Mel Williams, who had all very kindly donated money specifically towards the Outdoor Classroom.

Heather Tarrant - Chairman Friends of Botley School
chair@botleyfobs.co.uk
www.botleyfobs.co.uk
www.facebook.com/fobshampshire





READ ALL ABOUT IT?

BOTLEY NEWS is the Parish Council's newsletter, delivered to all residents three times a year, in the Spring, late Summer/ Autumn and in the Winter. It's useful to keep you in touch with Council news and local organisations and events.

Copies to a few outlying properties are posted, but it is not cost effective to post to all households. The vast majority of newsletters have always been delivered by volunteers and the Council are very thankful for their help. However, some existing volunteers are beginning to feel that they might like to retire; at the same time the new houses being built mean that there are more houses to deliver to. This is going to become more of a problem as time goes on. We are getting to a point where the distribution system needs to be reviewed and altered somewhat.

Rather than giving a few volunteers a large number of copies to deliver (some community minded people have been delivering over a hundred copies each), it would be a good idea to have more deliverers with less copies to take round - less weight to carry and less far to walk.

So if you feel that you could deliver Botley News just in your road, three times a year we would love to hear from you. It doesn't matter if perhaps there are only a dozen houses; in the words of the well known store 'every little helps'. If you live in a longer road perhaps a neighbour could share the job; one side each?

Please contact the Parish Office 01489 787181 if you can help - we would love to hear from you.

Or send an email to deborah.barnes@botley.com

(If you are an existing deliverer please contact the Parish Office and tell us if you are happy to continue to help.)



Parish Council Meetings

The Council's meetings take place at 7.15pm on the second Tuesday of every month. Planning & Highways Committee meetings start at 7.15pm on the fourth Tuesday of each month, followed at 8.15pm by either the Recreation or Policy & Resources Committee. Meetings are open to the public and are held in either the Diamond Jubilee Hall or in the Committee Room at the Botley Centre. See Parish Council notice boards for dates and agenda details.

Parish Councillors

Councillor	Address	Telephone	E-mail
Ronald Clark	19 Rowley Drive SO30 2SN	01489 690218	ron.clark@botley.com
Mrs Jenni Fletcher	52 Tripps End Mobile Home Park Hedge End SO30 0FW	07851 832179	Jenni.fletcher@botley.com
Mrs Sue Grinham	8 Ravenscroft Way, SO32 2FZ	01489 781680	Sue.grinham@botley.com
Roger Hann	9 Crows Nest Lane, SO32 2DD	01489 795299	Roger.hann@botley.com
Graham Hunter Vice Chairman	13 Salwey Road SO30 2SX	01489 785501	graham.hunter@botley.com
Jeffrey Jones	54 Precosa Road SO30 2NX	01489 785659	jeffrey.jones@botley.com
Rupert Kyrle Also Borough & County Cllr for Botley	6 Sherwood Ave, Hedge End SO30 0YJ	02380 407045	rupert.kyrle@botley.com
Colin Mercer Chairman	Shapwick, Brook Lane SO30 2ER	01489 784246	colin.mercer@botley.com
Angel Myerscough Also Borough Cllr for Botley	51 Precosa Road SO30 2NW	07713 496600	Angel.myerscough@botley.com
Adrian Trace	Montague House, Broad Oak SO30 2EU	01489 690322	Adrian.trace@botley.com
Kevin Williamson	9 Holmesland Walk SO30 2DZ	01489 787181 (contact via Parish office)	kevin.williamson@botley.com

Clerk to the Parish Council

Mrs Janet Morgan, Botley Parish Council, The Botley Centre, High Street, Botley SO30 2ES
Telephone: 01489 787181 e-mail: parish.clerk@botley.com